



AMERICAN RESCUE PLAN ACT Expenditure Request

This fillable form is available on our website: www.leecountyil.com

SECTION 1: PROGRAM OVERVIEW/ELIGIBILITY

Lee County is the recipient of Coronavirus State and Local Fiscal Recovery Funds, established by the American Rescue Plan Act (ARPA) of 2021. The Lee County Board established an ARPA Committee to make recommendations to the Board on funding allocations which meet eligibility guidelines and respond to local needs. Pursuant to the Act, funding objectives include supporting the COVID-19 Public Health Response, addressing negative economic impacts, replacing public sector revenue loss, premium pay for essential workers, and water, sewer, and broadband infrastructure.

For more information on U.S. Treasury's ARPA guidelines and eligibility go to: U.S. Treasury - ARPA Information. For information on the Lee County ARPA program, email Sara Leisner, Lee County ARPA Grant Coordinator at arpa@countyoflee.org.

SECTION 2: REQUESTING AGENCY/DEPARTMENT CONTACT INFORMATION (PLEASE PRINT)

Agency Lee County Highway Department Agency Phone 815-857-4141
Agency Address 1629 Lee Center Road, Amboy, IL 61310
Agency Representative David Anderson Title County Engineer
Representative Email leecoeng@comcast.net Phone 815-857-4141

SECTION 3: REQUEST OVERVIEW

Brief Description of Project/Expenditure: Facility maintenance and modernization

Estimate of the Timeline for Project/Expenditure: 2023

ARPA Category this Expenditure Falls Under:

- Support COVID-19 Public Health Response
Address Negative Economic Impacts
Replace Public Sector Revenue Loss
Premium Pay for Essential Workers
Water and Sewer Infrastructure
Broadband Infrastructure

Have you sought other funding or matching funds for this project? Yes No

If yes, from where:

Total Project Cost: \$ 1,829,500 ARPA Funding Request: \$ 1,829,500 Other Funding/Match: \$ 0

SECTION 4: DETAILS OF PROJECT/EXPENDITURE (ATTACH TO THIS APPLICATION)

Please attach a narrative detailing the project, including an explanation of how this expenditure meets the ARPA eligibility guidelines, any additional details on the project costs (including if the cost is an estimate), other funding sources, and the project timeline. Attach the narrative along with all supporting documentation to this application.

SECTION 5: SIGNATURE

I hereby depose and say that I am an authorized representative of the Agency, that I have read this application, that I have personal knowledge of the contents thereof, that the same is true in substance and fact, and that I will comply with all grant and reporting requirements to Lee County on behalf of the Agency.

Signature of Agency Representative

Date 4/27/2022

Email this application and all supporting documentation to Sara Leisner, Lee County ARPA Grant Coordinator at arpa@countyoflee.org.

**American Rescue Plan Act Expenditure Request
Supplemental Narrative for
Section 4: Details of Project/Expenditure.**

Highway Department Facilities Maintenance and Modernization Project

The proposed project consists of updating and maintaining the facilities at the County Highway Department. These facilities house and protect approximately \$1.1 million of equipment and \$250,000 of material. Keeping the equipment in good condition and working order is not only in the financial interest of the public, but also a matter of safety, since much of this equipment is expected to perform well in adverse winter weather conditions to keep the County highways as clear as possible. **Exhibit 1** is an aerial photo of the facility and alphabetically references the areas of interest in this application. These references are consistent as cross references throughout this narrative in addition to the cost estimate in **Exhibit 2**. Each facet of the project will be described below in alphabetical order as shown on **Exhibit 1**.

Exhibit 1 Reference A (Re-Roof Shop and Garage):

The shop and garage were built 44 years ago. Two years ago the original roof was leaking badly in several locations, including onto a circuit breaker box. At this time, a roof sealer was applied to buy time until funding became available for and new roof and insulation.

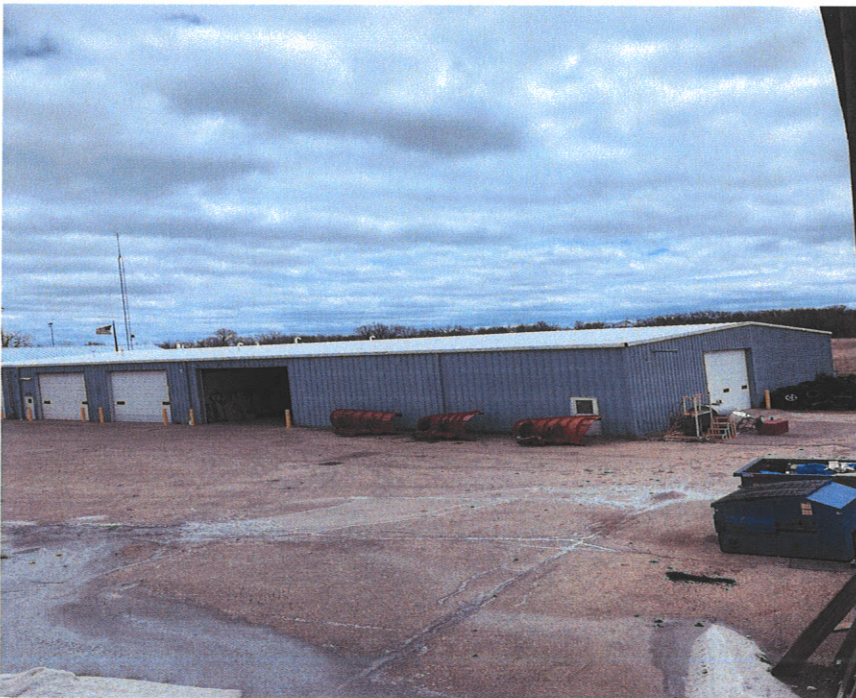

Roof Sealer applied in 2020. Only a short term repair.

Exhibit 1 Reference B (Re-Side and Re- Insulate Shop and Garage):

The 44 year old siding has several dents, holes, and scrapes. The insulation is in need of an upgrade to stay somewhat current with energy efficiency standards that today's buildings require.



Siding repairs, typical of several areas.

Exhibit 1 Reference C (Add Air Exchangers, Additional Heat and other Shop Upgrades):

Whether in the shop or the storage shed, trucks are constantly melting off accumulated ice and snow and creating a wet saline environment in the winter. Air exchangers will keep both of these areas dry and limit the amount of corrosion on the plow trucks. The heating system in the cold storage is in poor condition and makes it difficult to get trucks thawed out and ready for the next day's plowing activities. In addition, the shop floor has been compromised with salt water for 44 years and is in need of an epoxy covering to protect the slab and provide for a serviceable surface for truck maintenance.



Concrete on the shop floor has degraded over time and needs a new surface, in addition to other items for modernization mentioned above.

Exhibit 1 Reference D (Extend Equipment Storage by 95 feet):

The truck storage adjacent to the shop was fitted for the size of trucks 44 years ago. Newer trucks are larger and with the addition of mid-mount wings, they take up considerably more space than their older counter parts. As a result, trucks are crammed into tighter spaces, which increases the risk of property damage in addition to generating safety concerns for the drivers. An addition to this building would alleviate these issues.



Existing truck storage adjacent to the shop. Area becomes very cramped with plows and wings attached to the trucks during winter operations.

Exhibit 1 Reference E (Provide a Hoop Structure over Outside Salt Storage):

In order to ensure adequate salt supplies for winter operations it is sometimes necessary to pile salt outside in the existing bin. It is then covered with a tarp and weighted with tires to protect the salt. When the tarp is applied, accessing the salt becomes very difficult. A hoop structure would allow easy access at all times. It can also double as equipment storage space when there is no need to store salt.



Existing outside salt storage

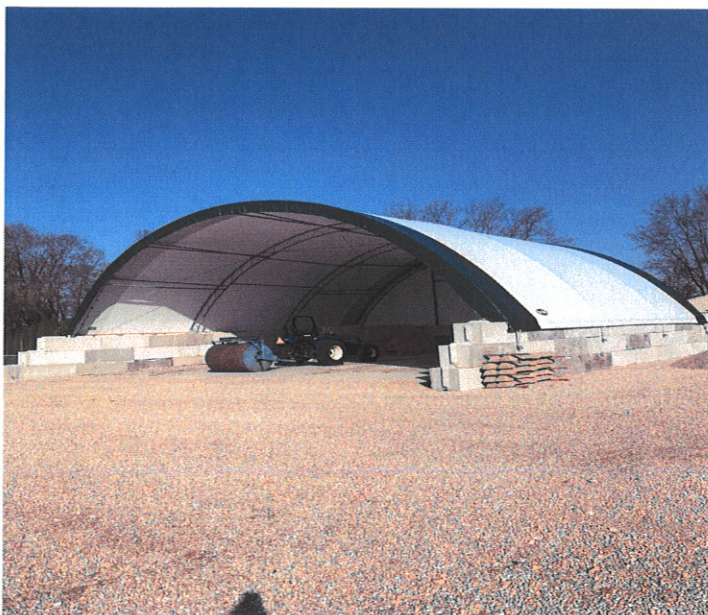

Example of hoop structure at the City of Amboy's Facility



County Highway Department

*David M. Anderson, P.E.,
County Engineer
1629 Lee Center Road, PO Box 193
Amboy, IL 61310
Phone: 815-857-4141
Fax: 815-857-4242
Email: leecoeng@comcast.net*

Exhibit 1 Reference F (Install sliding Gate and concrete under lean-to):

The above is necessary to better utilize an area that is currently dead space and clean up some of the material that creates a neighborhood eyesore. After the concrete is in place the department will erect shelving for material storage.



Respectfully Submitted,

A handwritten signature in blue ink that reads "D. M. Anderson".

David M. Anderson, P.E.
Lee County Engineer



County Highway Department

*David M. Anderson, P.E.,
County Engineer
1629 Lee Center Road, PO Box 193
Amboy, IL 61310
Phone: 815-857-4141
Fax: 815-857-4242
Email: leecoeng@comcast.net*

Exhibits

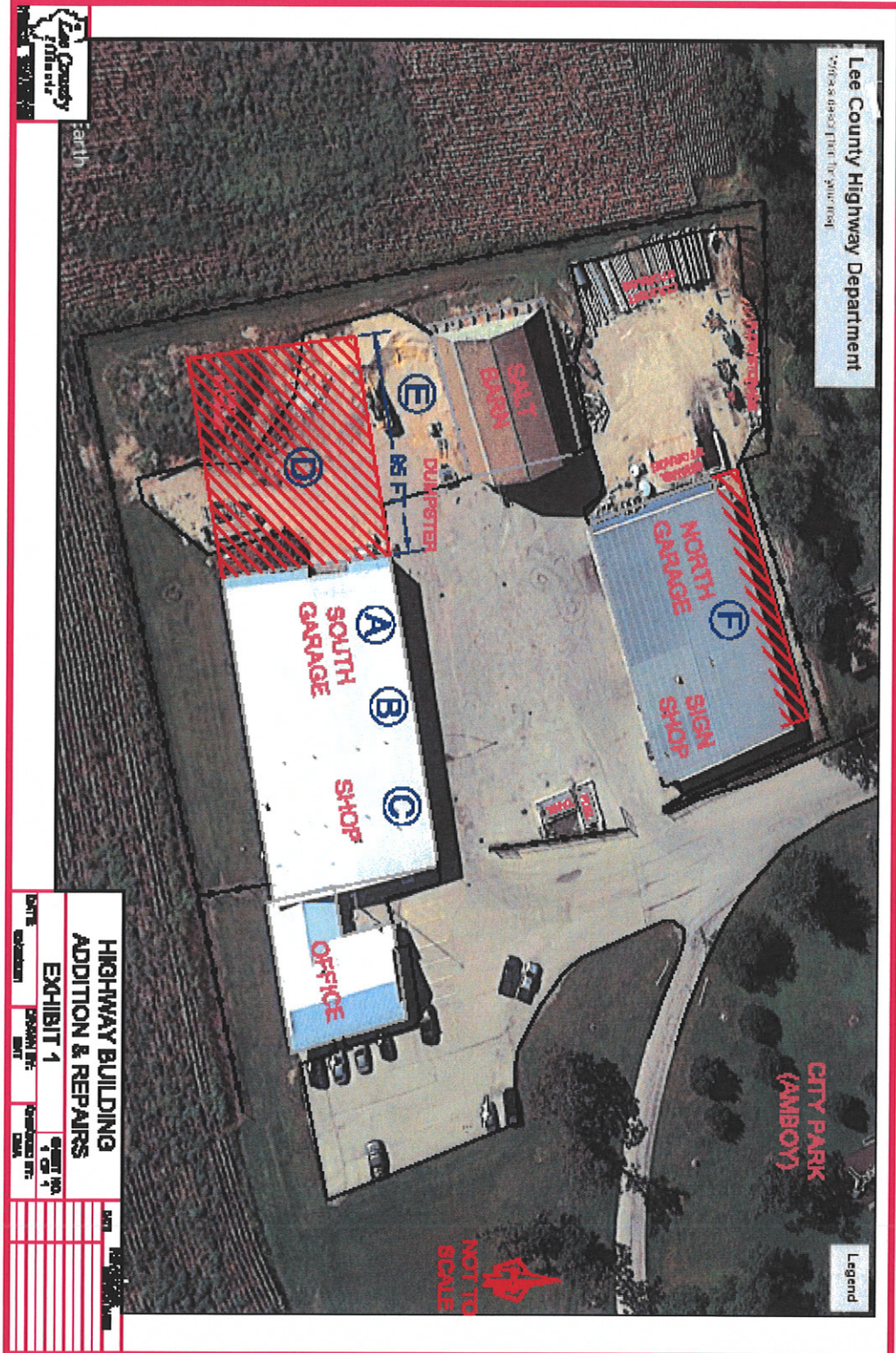



County Highway Department

*David M. Anderson, P.E.,
 County Engineer
 1629 Lee Center Road, PO Box 193
 Amboy, IL 61310
 Phone: 815-857-4141
 Fax: 815-857-4242
 Email: leecoeng@comcast.net*

Highway Department Facilities Maintenance and Modernization					
Estimate of Cost					Exhibit 2
Map	Item Description			Unit	
Reference		Quantity	Unit	Cost	Cost
A	Re-Roof Shop and Garage	12,000	SF	\$ 35	\$ 420,000
B	Re-Side and Re-insulate Shop and Garage	7,500	SF	\$ 35	\$ 262,500
C	Air Exchangers/Additional Heat/Shop Upgrades	1	LS	\$ 200,000	\$ 200,000
D	Extend South Equipment Storage 95'	7,600	SF	\$ 65	\$ 494,000
E	Provide Hoop Covering Over Outside Salt Storage	1	LS	\$ 75,000	\$ 75,000
F	Sliding Gate & Concrete under lean-to	18,000	SF	\$ 21	\$ 378,000
				TOTAL =	\$ 1,829,500